

- DESIGNED TO ADAPT TFOCA I INTERFACES TO EXPANDED BEAM TECHNOLOGY.
- CAN BE USED TO DAISY CHAIN CABLE ASSEMBLIES

PART. NO.		900-0620		SH	1	REV.	02
REV.	SCN NO.	REVISIONS		BY	DATE	APVD.	
01		PRELIMINARY CUD RELEASE		JED	10-08-14		

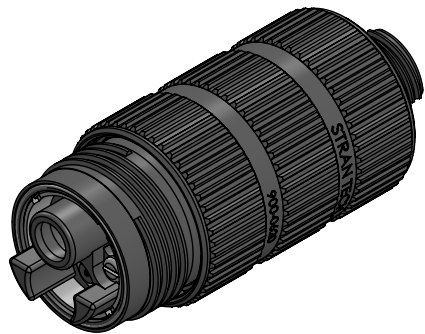
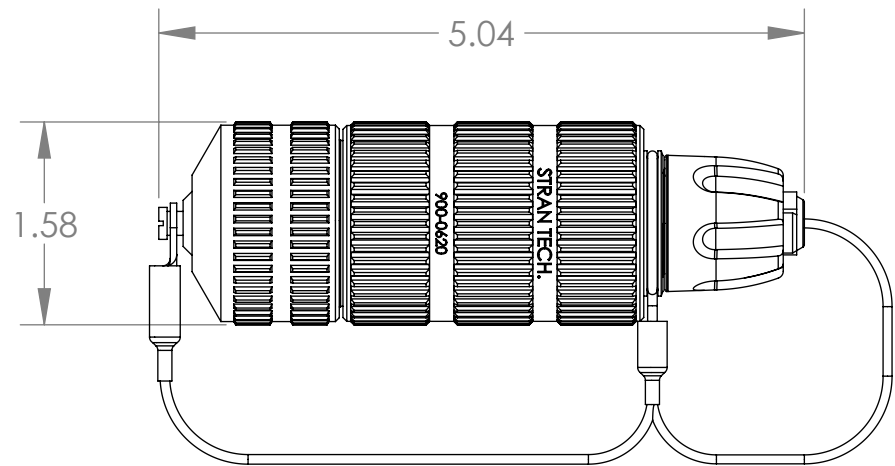
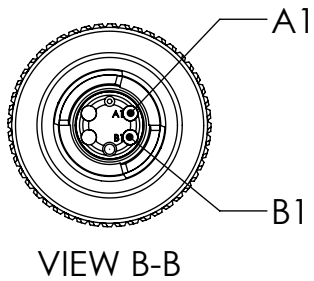
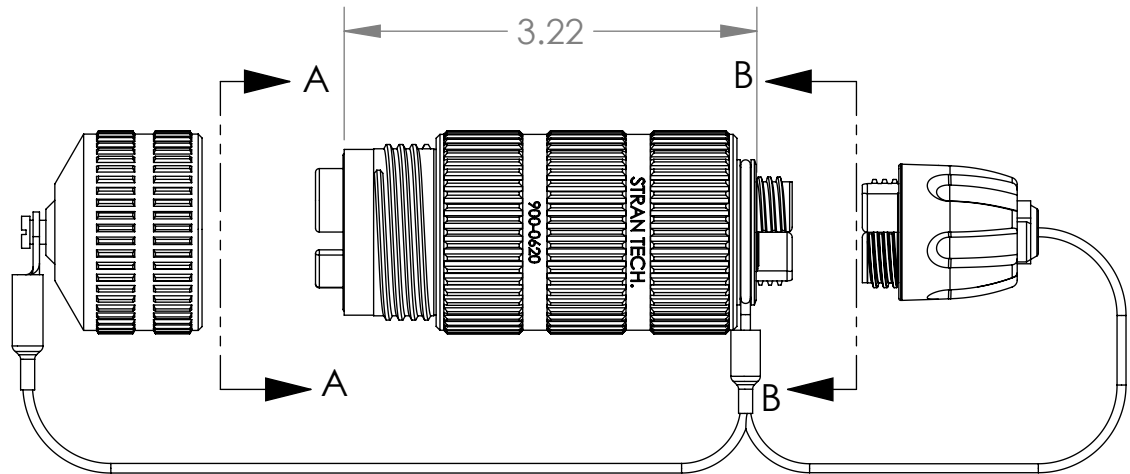
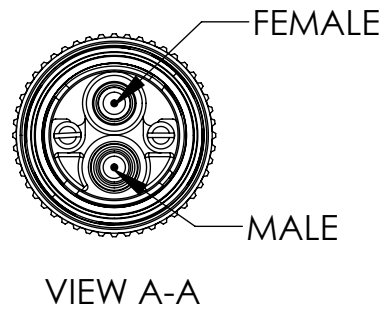

PINOUT TABLE	
FROM	TO
FEMALE	A1
MALE	B1

NOTES:  
1. MAX MULTIMODE LINK LOSS: 3.0 dB @ 850nm

NEXT ASS'Y	USED ON
APPLICATION	

TOLERANCES		DRAWN BY	DATE
.0	± -	JED	10-08-14
.00	± -	CHECKED BY	DATE
.000	± -	APPROVED BY	DATE
.0000	± -		
ANGLES	± -		
UNLESS OTHERWISE SPECIFIED ALL DIMENSIONS ARE IN INCHES. ALL DIMENSIONS APPLY AFTER PLATING.			
THIRD ANGLE PROJECTION			
THIS DOCUMENT CONTAINS PROPRIETARY INFORMATION OF STRAN TECHNOLOGIES AND IS DELIVERED ON THE EXPRESSED CONDITIONS THAT IT IS NOT TO BE DISCLOSED OR REPRODUCED IN WHOLE OR PART, OR USED FOR MANUFACTURING FOR ANYONE OTHER THAN STRAN TECHNOLOGIES WITHOUT ITS WRITTEN CONSENT AND THAT NO RIGHT IS GRANTED TO DISCLOSE OR SO USE ANY INFORMATION CONTAINED IN SAID DOCUMENT.			

CORNING		
39 GREAT HILL RD, NAUGATUCK, CT 06770 (203) 729-2572		
ADAPTER, TFOCA I TO EXPANDED BEAM		
DWG. SIZE	PART NO.	REV.
B	900-0620	02
SCALE	SHEET 1 OF 1	

CAGE CODE: 1HVU5

NONE

SHEET 1 OF 1

CUSTOMER USE DRAWING

PART NO. 900-0620 SH 1 REV. 02